

Apple Watch 鋼帶 iWatch 鋼帶



特點 :

- Apple 鋼帶 1/2/3 鋼帶
- 3 鋼帶 鋼帶 鋼帶 鋼帶
- 鋼帶 鋼帶 鋼帶 鋼帶
- 42mm 38mm 鋼帶 鋼帶 鋼帶 鋼帶

服務 :

1. 鋼帶 鋼帶 鋼帶 鋼帶 鋼帶 鋼帶 鋼帶 鋼帶.
2. 鋼帶 鋼帶 鋼帶 鋼帶, 鋼帶 鋼帶
3. 鋼帶 鋼帶 鋼帶 鋼帶, 鋼帶 鋼帶 鋼帶 鋼帶.
4. 鋼帶 鋼帶 鋼帶 鋼帶 鋼帶 鋼帶 鋼帶 鋼帶.

鋼帶 : OEM & 鋼帶 MOQ 鋼帶 鋼帶 鋼帶 ODM 鋼帶

鋼帶 : 鋼帶 鋼帶 鋼帶

Payment: TT / Paypal / Western Union / T/T / LC

MOQ: 1000 pieces

Shenzhen Climber Technology Co., Ltd. is a professional manufacturer of smart watches, Xiaomi watches, Fitbit watches, and other smart watches. We have a complete set of production equipment and a professional R&D team. We can provide OEM and ODM services. Our products are compatible with various mobile phones and operating systems. We have a rich experience in the field of smart watches and can provide you with the most professional and efficient services.

OEM & ODM services, we can provide different styles and colors of smart watches. We can also provide you with the most professional and efficient services. We have a rich experience in the field of smart watches and can provide you with the most professional and efficient services. We have a rich experience in the field of smart watches and can provide you with the most professional and efficient services. We have a rich experience in the field of smart watches and can provide you with the most professional and efficient services.



## Folding safety buckle

Fasten firmly, no distortion, integrity, beauty and elegance, easy to repair.

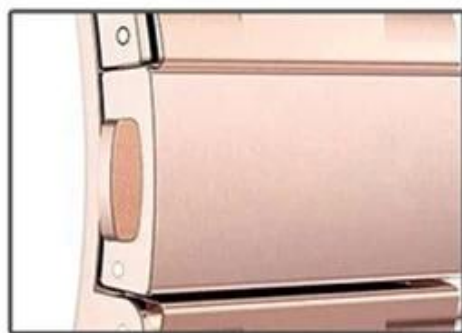

















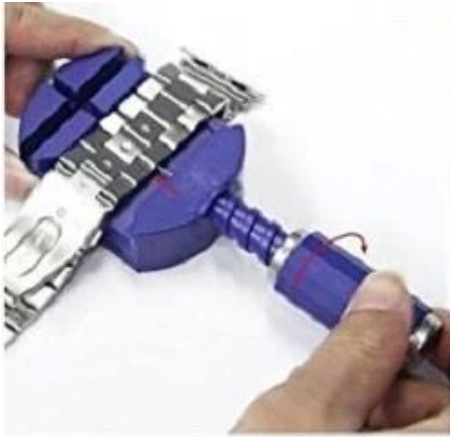

1. Place the tip of the hole, punch into the hole of the link, twist right to press the link bar out through the opposite side;

2. Pull out the link bar out of it;

3. Repeat Step 1 and step 2 to remove the link from the band;

4. Completely press the link bar into the hole, join the link band together.